

## INSTALLATION GUIDE FOR REGULAR FORMAT ACCESS PANEL

### STEP 1

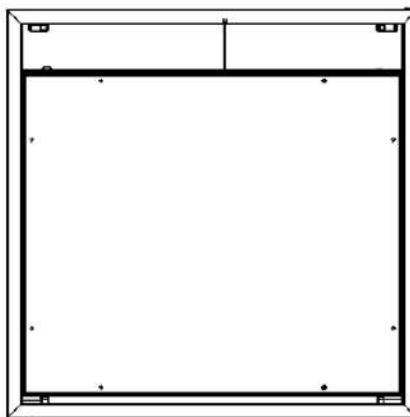
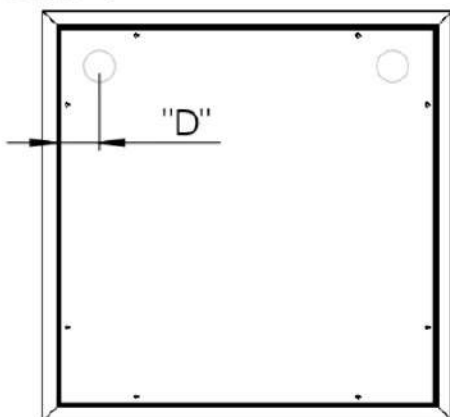

Press and release at the given position from both sides at the same time to unlock the push latches as shown in the figure.  
**D= 30-40mm**

### STEP 2

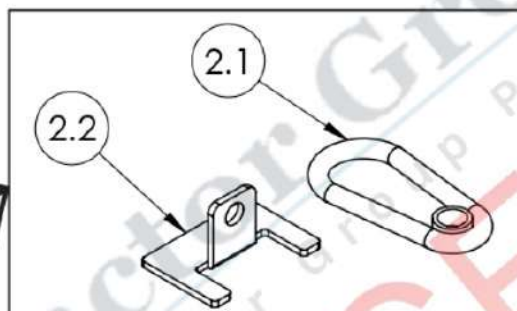
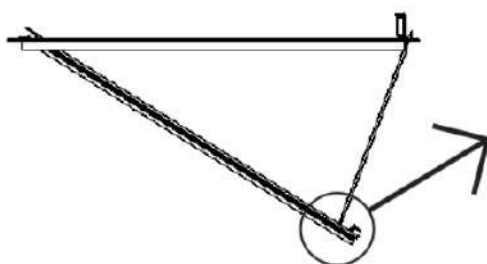

Unlock the snap hook of the safety latch(2..1) from its attaching component(2.2)

### STEP 3

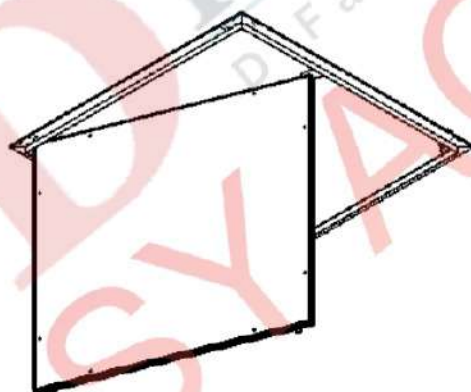

Tilt the Inner door to certain degree  $> 30$  until the free pivoting corner component is free to move and pull out the inner door safely

### STEP 4

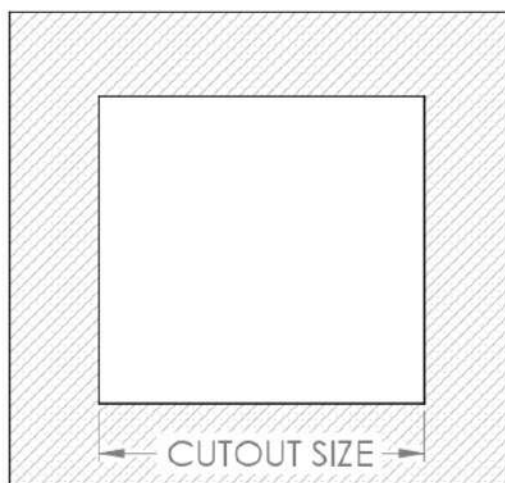
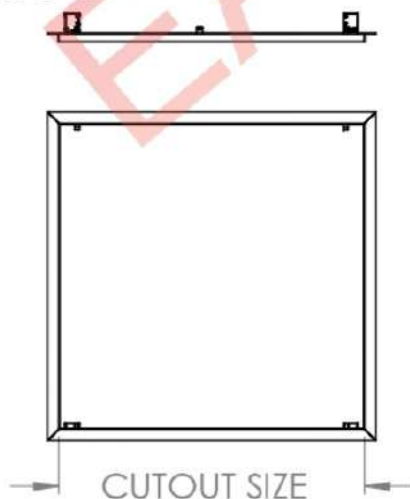

Measure the cutout lengths from the outer frame or by the below mentioned formula and the generate the slot in the existing ceiling accordingly.  
***Cutout length = Door size + 8mm***

### STEP 5

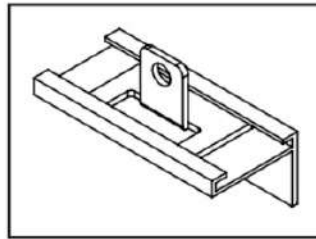
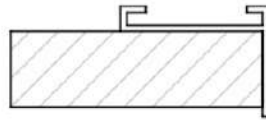
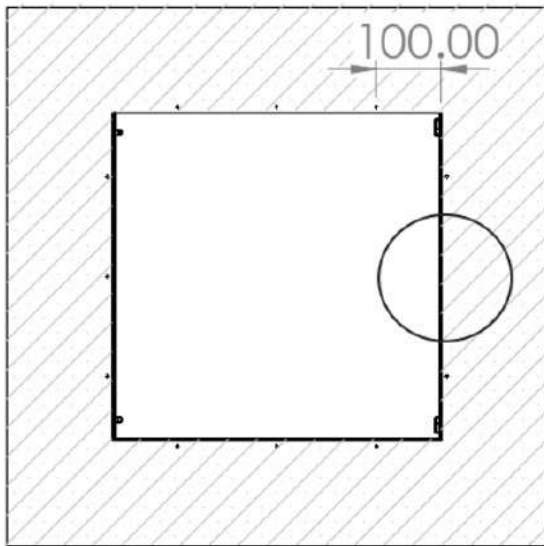

Place the outer frame in the cutout and check for any misalignment. Make markings for screwing the outer frame in the Gypsum ceiling. Take care of marking positions It should not damage the corner components of the Outer frame. (Refer the drawing). Use the gypsum screw to join the Outer frame

### STEP 6

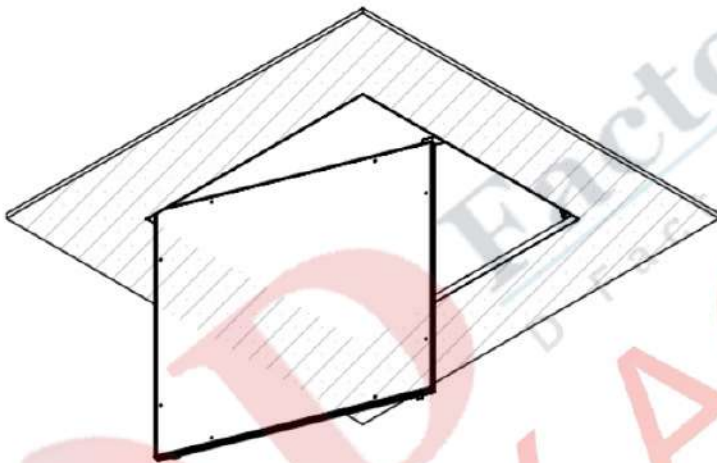

Insert the inner door carefully by tilting it to certain degrees  $>30$  ensuring no moving part is damaged

### STEP 7

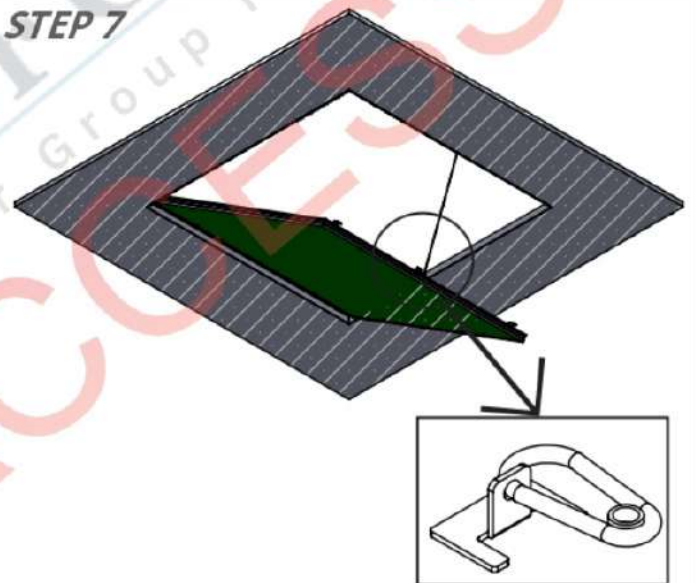

Attach the snaphook to the safety latch attaching component of inner door.

### STEP 8

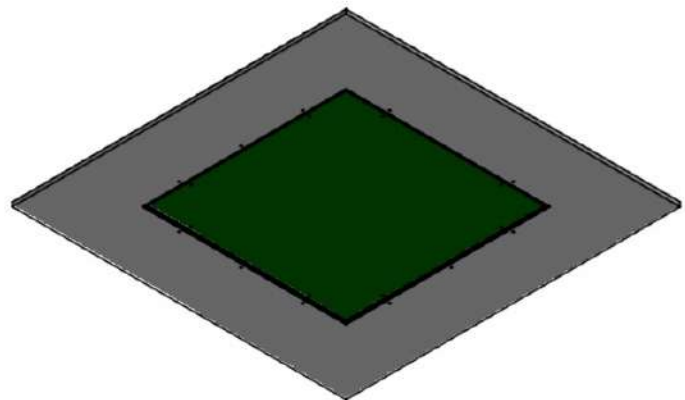
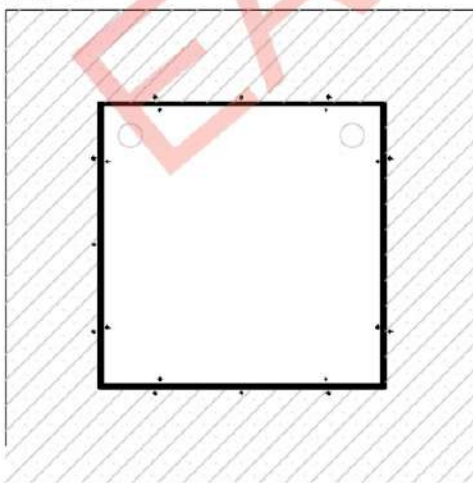

Press the inner door at specified location with both hands to secure its locking position and the Access panel is ready to go